

CONFERENCES  
& EVENTS



**London Hilton**

ON PARK LANE





## WELCOME TO LONDON HILTON ON PARK LANE

As one of the most famous hotels in the world, London Hilton on Park Lane is synonymous with outstanding service, excellence and style. Situated in the heart of Mayfair, the hotel offers stunning views of Hyde Park and the Capital's skyline from all guest rooms.

London Hilton on Park Lane has hosted many of the city's landmark events over the years. Everyone from kings to presidents, Hollywood nobility to the International Olympic Committee have passed through our doors. Our experience in event management ensures that no matter what the occasion, from high profile parties to intimate gatherings, the event is a success.









# LOCATION

## In the Heart of London

London Hilton on Park Lane is located on Park Lane, Mayfair, overlooking attractions such as Buckingham Palace and Hyde Park and just a short walk from the shopping districts of Knightsbridge, Bond Street and Oxford Street. Hyde Park Corner and Green Park tube stations are close by and there is an excellent local bus service. We are just a 10-minute taxi ride from either the Gatwick Express or the Heathrow Express.

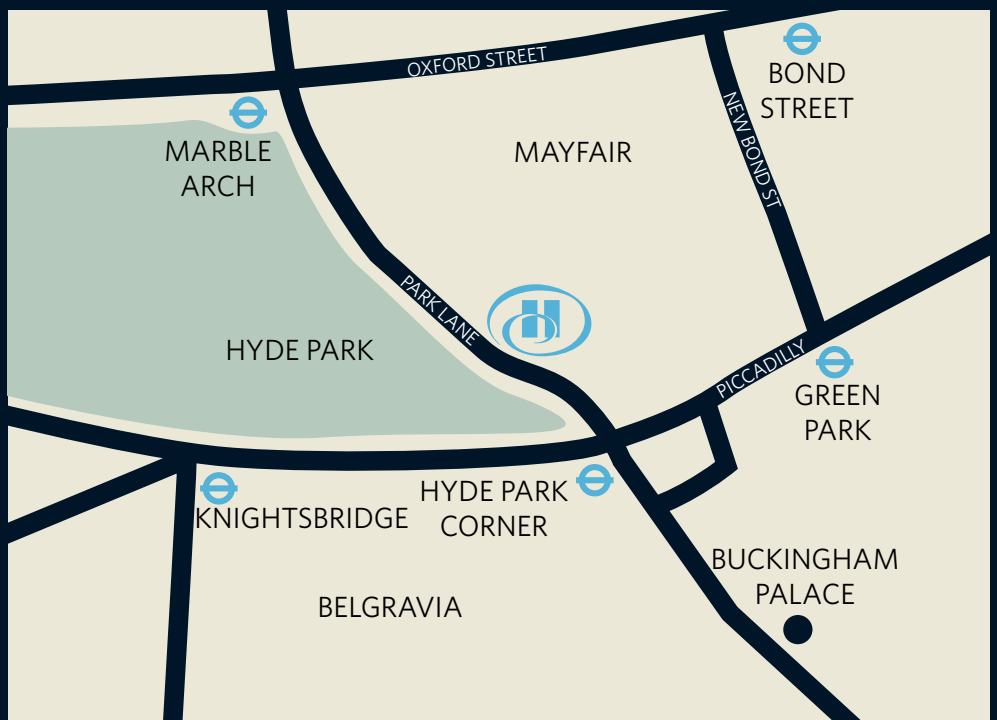



# AT A GLANCE

## OUR ROOMS

### GUEST ROOMS

Located on floors 5 to 11, these bright and airy rooms enjoy stunning views across Hyde Park and Knightsbridge. Decorated in tranquil tones and flooded by natural daylight, Guests can relax in front of the 37" plasma TV screen, enjoy on-demand movies and reinvigorate in the stylishly amenable bathroom.

### DELUXE ROOM

Our Deluxe rooms, located on floors 12 to 17, allow our Guests to enjoy impressive birds-eye views of London from a higher panorama. These fresh and contemporary rooms offer a relaxing retreat high above the bustle of the city, with in-room window seats providing the perfect vantage point. Make use of the convenient work space, 37" plasma TV screen and In-Room Dining service 24 hours, 7 days a week.

### EXECUTIVE ROOMS

Upgrade to one of these bright and spacious rooms, located on floors 18 to 27. Boasting spectacular views over London and beyond, our Executive rooms provide exclusive access to the Executive Lounge and feature additional amenities such as bathrobes and slippers.

### SUITES

From stunning one-bedroom Park Lane suites overlooking Hyde Park to our magnificent Royal and Presidential suites, there is something to suit every taste. Our 56 suites are available in ten sumptuous styles, each offering unparalleled views across London. In addition our Royal and Presidential suites offer the benefit of butler service (chargeable).

The Executive Lounge is also available for all Guests staying in suites. Enjoy the benefit of wireless internet, private Check-In/Out, shower facilities, complimentary Continental breakfast, afternoon tea and evening canapés.

## EAT & DRINK

### GALVIN AT WINDOWS RESTAURANT & BAR

Located on the 28<sup>th</sup> Floor, Michelin-starred Galvin at Windows offers seasonally inspired modern French cuisine in stylish surroundings. Visit the bar for innovative cocktails and enjoy breathtaking 360° views of London.

### TRADER VIC'S RESTAURANT & BAR

Home of the Mai Tai cocktail and nightly live music. Traditional Tiki carvings adorn the walls of this colourful tropical bar, which serves modern French Polynesian-style cuisine.

### PODIUM RESTAURANT & BAR

Sample seasonal European cuisine at contemporary Podium Restaurant & Bar, or treat yourself to our famous afternoon tea.

### CC BAR

Located on the Lobby Level, this upscale London Champagne Bar transports you under the vines. Enjoy a wide selection of Pommery Champagne, signature champagne cocktails and premium spirits whilst taking in the sparkling atmosphere.

### WHISKY MIST AT ZETA

Popular with London's glamorous glitterati and celebrities, Whisky Mist at Zeta is the ideal place for a sophisticated evening drink or a stylish all-night party.

## OUT & ABOUT

- Overlooking Hyde Park
- Moments from Buckingham Palace
- Explore Oxford Street, Bond Street and Knightsbridge shopping areas - all near the hotel
- Hyde Park Corner and Green Park London Underground stations are within a 5-minute walk
- Frequent buses outside hotel's main entrance

## OUR FACILITIES

### HILTON FITNESS BY PRECOR®

Complimentary entry to Hilton Fitness by Precor® awaits all Guests staying at London Hilton on Park Lane. Open 24 hours, 7 days a week, benefit from our state-of-the-art cardiovascular equipment, separate personal training rooms, or relax in the sauna or steam room.

### SPA TO YOU

Indulge in pure calm and relaxation whilst pampering yourself with a range of luxurious massages, facials and alternative treatments.

### OTHER FACILITIES

The hotel also offers the following facilities to meet your every need.

- Stay connected - complimentary wireless internet for emails and web browsing throughout the hotel.
- Barber shop - everything from hair styling to wet shaves.
- Newsagent - international newspapers and magazines, gifts, souvenirs and any last minute shopping.



# GRAND BALLROOM

Ideal for all occasions, the Grand Ballroom is one of the largest hotel ballrooms in London, suitable for the most glamorous of events.

From its dedicated Reception foyer to the stylish interior and grand stairwell entrance, it is the ideal large-capacity venue, accommodating up to 1,250 guests.

Entirely adaptable, the Grand Ballroom features special sets and lighting, and impressive crystal chandeliers, so it can be tailored to your exact needs. It can also be subdivided into three separate rooms, each keeping the same exclusive feel. Featuring the latest audiovisual facilities, including sound reproduction of broadcast quality, the Ballroom allows for television coverage of the event.

- 01 Grand Ballroom
- 02 Foyer
- 03 Dome
- 04 Registration area
- 05 Lifts
- Pillars
- Pillars

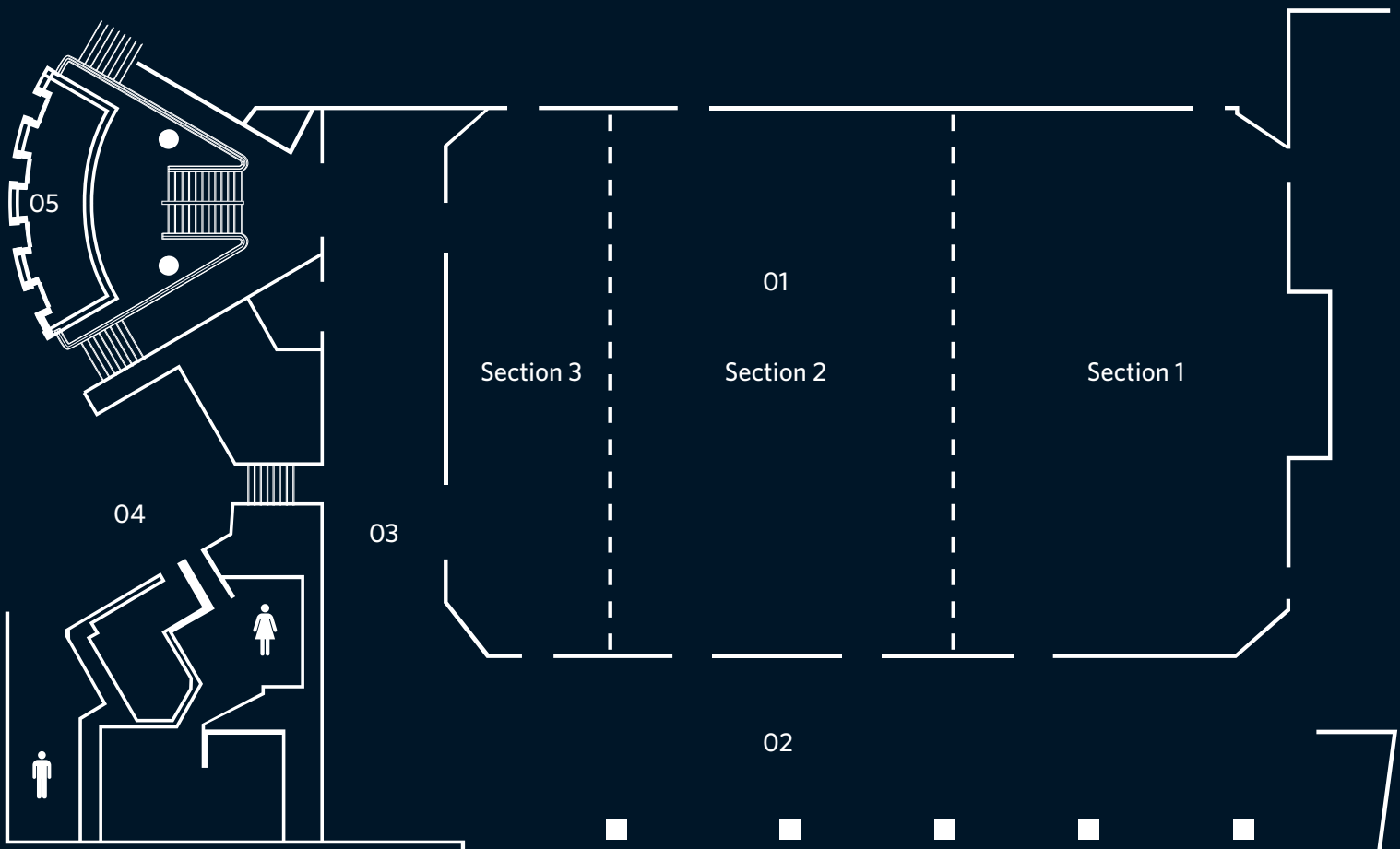



## CAPACITIES AND DIMENSIONS

	Theatre	Classroom	Cabaret	Boardroom	U Shape	Banquet	Dinner Dance	Reception	H Square	Dimension (LxWxH) feet	Dimension (LxWxH) metres	Area feet	Area metres
<b>GRAND BALLROOM</b>													
Section 1	350	200	250	60	80	300	—	400	100	47x80x17	14.3x24.4x5.2	3,755	349
Section 2	400	300	250	60	120	350	250	450	100	47x80x17	14.3x24.4x5.2	3,381	356
Section 3	180	120	100	60	80	120	—	200	90	27x80x17	8.2x24.4x5.2	2,160	200
Complete	1,200	600	650	180	200	1,000	900	1,250	230	126x80x17	38.4x24.4x5.2w	10,082	937
Foyer	200	100	—	50	—	—	—	450	—	29.5x121x9.4	9x37x2.8	3,346	311
Dome	—	—	—	—	—	—	—	150	—	71.2x12.5x9.4	21.7x3.8x2.8	888	82.5



# WELLINGTON BALLROOM AND HARVEST SUITE

Bathed in natural light through floor-to-ceiling windows by day and illuminated by spectacular chandeliers by night, the stunning views from the Wellington Ballroom will give any occasion an impressive and authentic edge. The Wellington Ballroom also benefits from the connecting and alluring Harvest Suite, ideal for pre-reception drinks for stylish events.

The ultimate desirable location for any conference or event, offering magnificent vistas over Hyde Park and Park Lane. Under the stylish veneer lies a 3-phase power outlet, full PA system and air conditioning, meaning it is equipped for any event. Being completely adaptable, this impressive venue can accommodate anything from a wedding or banquet to a board meeting.

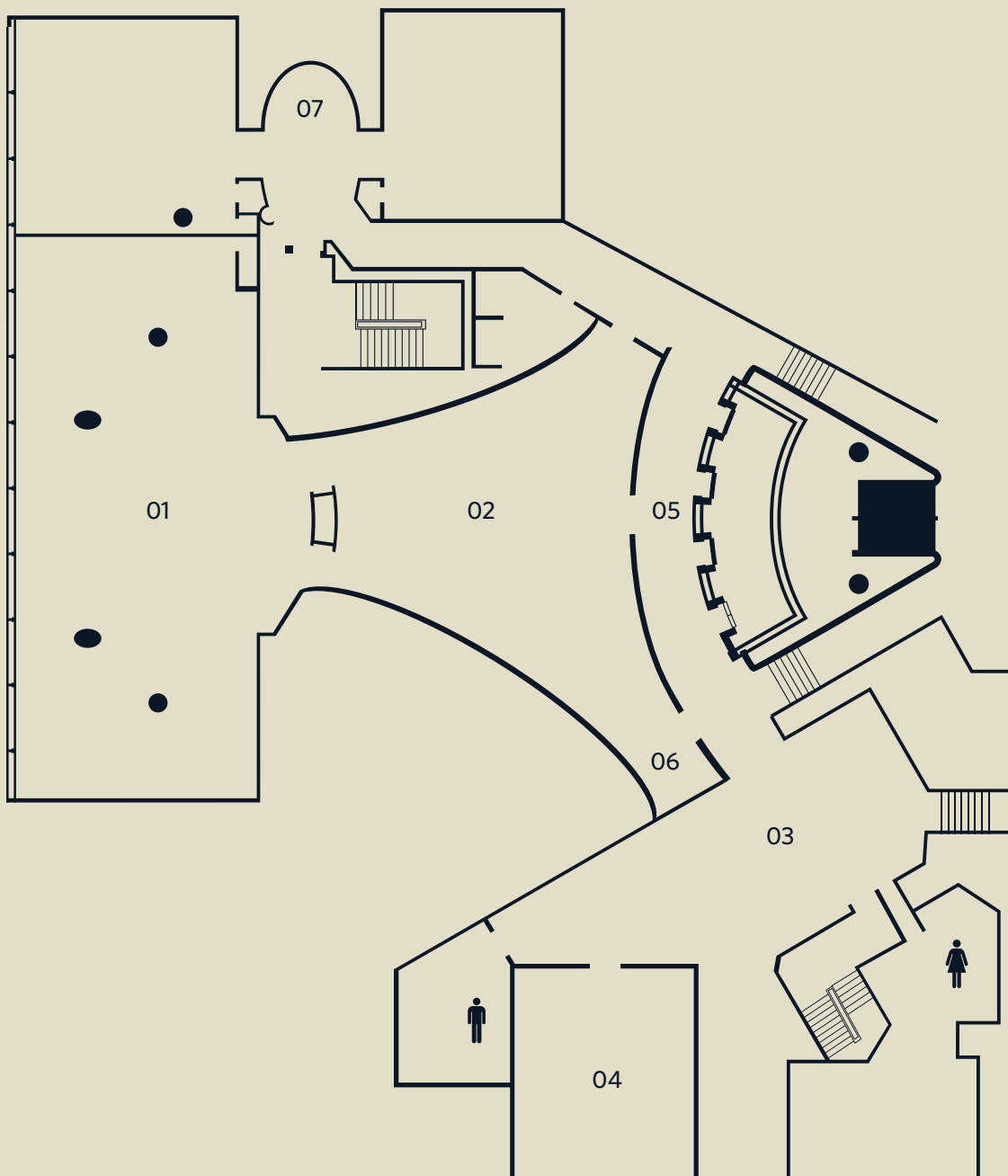

- 01 Wellington Ballroom
- 02 Harvest Suite
- 03 Registration area
- 04 Cloakroom
- 05 Lifts
- 06 Entrance
- 07 Executive Lounge
- Pillars
- Windows



## CAPACITIES AND DIMENSIONS

	Theatre	Classroom	Cabaret	Boardroom	U Shape	Banquet	Dinner Dance	Reception	H Square	Dimension (LxWxH) feet	Dimension (LxWxH) metres	Area feet	Area metres
WELLINGTON BALLROOM AND HARVEST SUITE BALLROOM													
Wellington	200	80	80	30	30	180	150	550	30	76.5x26.9x16.1	23.3x8.2x4.9	2,506	191
Harvest Suite	90	60	60	30	45	100	—	200	50	40x34.7x16.4	12.7x10.6x5	1,431	133



# CRYSTAL PALACE SUITE

Whether flooded in natural light or lit up by magical candlelight in the evening, the Crystal Palace Suite is perfect for occasions from a banquet for 110 to a more intimate, personal dinner for 50.

It is also ideal for a dinner dance, as a dance floor can be added, and the stylish mirrored walls hide an integrated sound system. The Crystal Palace Suite features a dedicated foyer and registration area and has splendid views of Park Lane.

## CAPACITIES AND DIMENSIONS

	Theatre	Classroom	Cabaret	Boardroom	U Shape	Banquet	Dinner Dance	Reception	H Square	Dimension (LxWxH) feet	Dimension (LxWxH) metres	Area feet	Area metres
CRYSTAL PALACE SUITE													
Crystal Palace	150	70	60	40	45	110	80	160	50	59x32.8x7.9	18x10x2.4	1,990	185

01 Crystal Palace Suite









## MEETING ROOMS

Proudly offering some of the best meetings and events facilities in the city, London Hilton on Park Lane hosts many prestigious conferences and meetings within the hotel's eleven modern and flexible venues, most of which have natural daylight.

From the latest audiovisual equipment, high speed wireless internet access, video conferencing and online facilities, to award-winning chefs, we ensure that every event is a success.





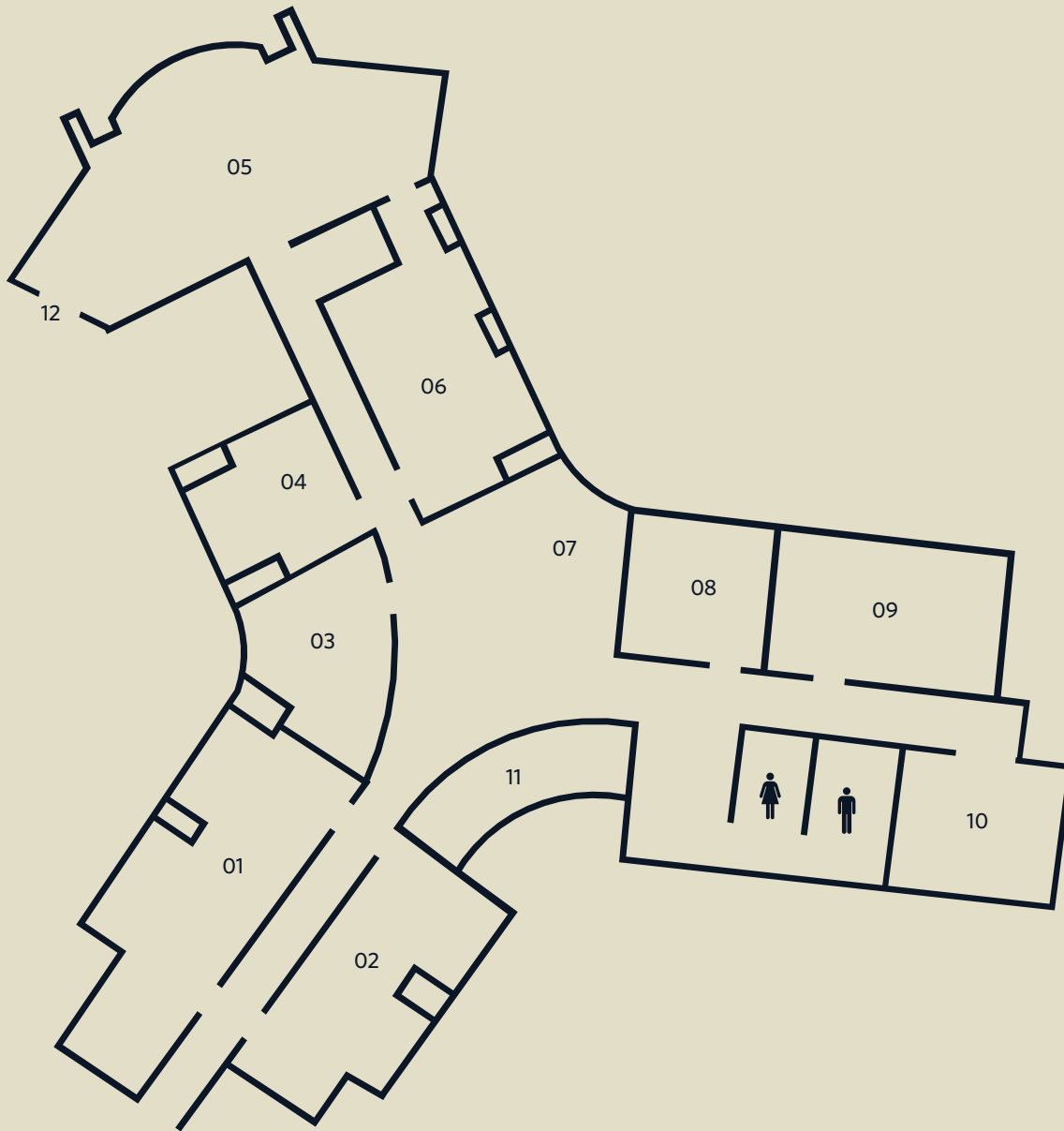

- 01 Boardroom
- 02 Spectra Suite
- 03 Argyll Suite
- 04 Business Centre
- 05 Serpentine Suite
- 06 Marlborough Suite
- 07 Hilton Meetings reception
- 08 York Room
- 09 Nelson Room
- 10 Atholl Suite
- 11 Lifts
- 12 Fire Exit

## CAPACITIES AND DIMENSIONS

	Theatre	Boardroom	Banquet	Reception	Dimension (LxWxH) feet	Dimension (LxWxH) metres	Area feet	Area metres
<b>FOURTH FLOOR MEETING ROOMS</b>								
Atholl Suite	—	4	—	—	16.4x8.5x8.8	5x2.6x2.7	131	12
Argyll Suite	20	16	16	40	29.5x16.4x8.9	9x5x2.7	377	36
Spectra Suite	20	16	20	50	25.5x11x8.9	7.8x3.4x2.7	282	29
Boardroom	—	16	—	—	28x11x8.9	8.4x3.5x2.7	312	29
Nelson Suite	—	10	—	30	18.8x11.1x8.5	5.7x3.4x2.6	208	19
York Suite	—	8	—	—	17.1x10.2x8.9	5.2x3.1x2.6	173.5	16

## SERPENTINE AND MARLBOROUGH SUITES

The Serpentine is the largest meeting room that can accommodate up to 50 delegates in a range of room layouts. It also benefits by being connected to the Marlborough Suite that can act as a break-out area.

It features all the modern facilities associated with a meeting room, such as air conditioning, flexible lighting and an abundance of natural light.





05 Serpentine Suite  
06 Marlborough Suite

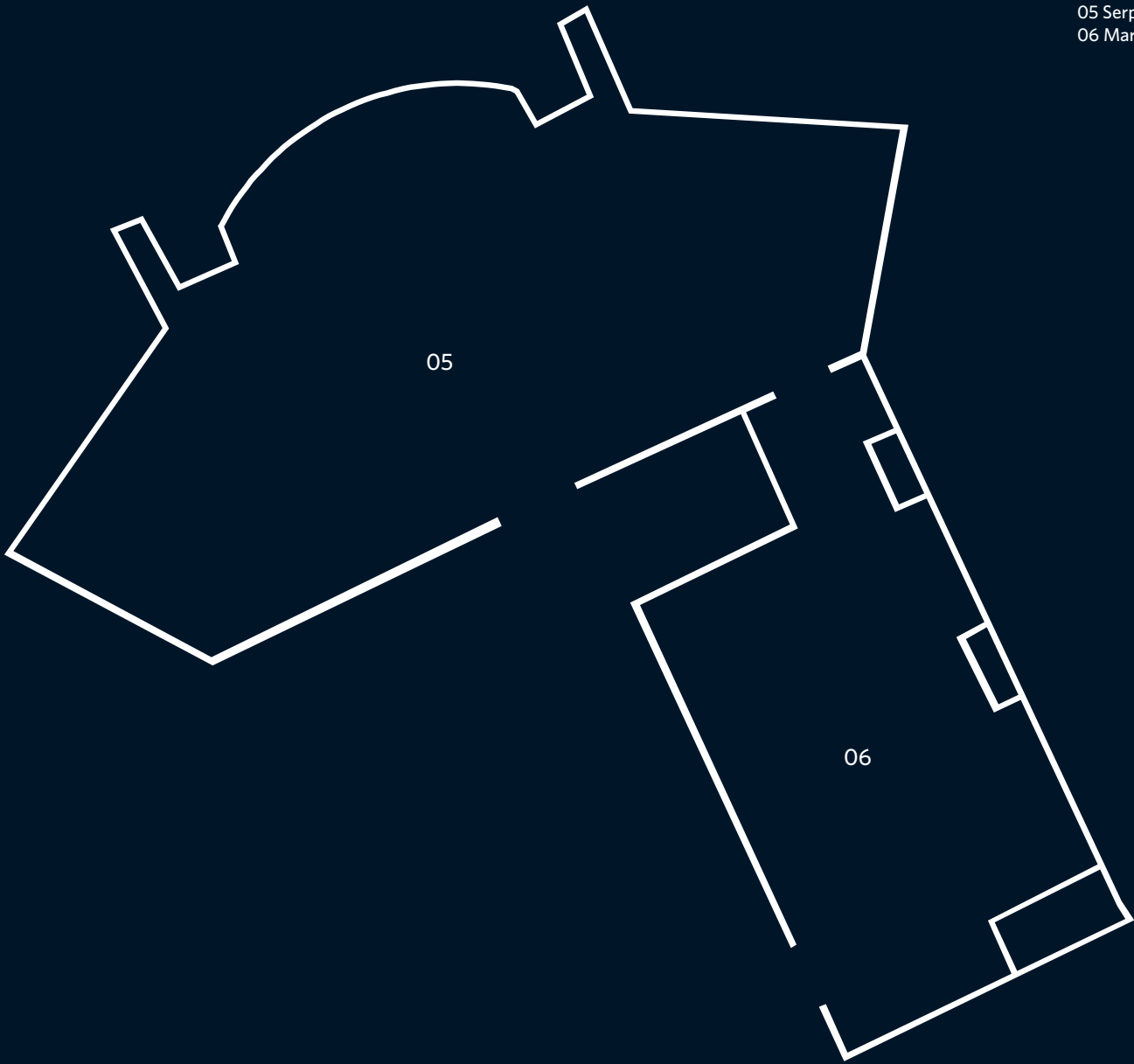

## CAPACITIES AND DIMENSIONS

	Theatre	Classroom	Cabaret	Boardroom	U Shape	Banquet	Reception	H Square	Dimension (LxWxH) feet	Dimension (LxWxH) metres	Area feet	Area metres
<b>MARLBOROUGH SUITE AND SERPENTINE SUITE</b>												
Marlborough Suite	20	—	—	18	—	20	50	—	27.8x10.8x8.9	8.5x3.3x2.7	409	38
Serpentine Suite	50	30	40	35	26	50	100	28	36.5x23.1x9.2	11.1x7.3x2.8	872	81









## THINGS TO DO

### HYDE PARK

Hyde Park is one of London's finest and most famous landscapes, covering over 350 acres, and is located just a short distance from the hotel. With over 4,000 trees, a lake, a meadow, horse riding and more, it is easy to forget you are in the middle of London.

### BUCKINGHAM PALACE

Within walking distance of the hotel, Buckingham Palace is the Queen's official London residence and is located between Green Park, Hyde Park and St. James's Park. Buckingham Palace is open to visitors during August and September while the Queen makes her annual visit to Balmoral Castle.

### LONDON EYE

The London Eye has become one of the most iconic sights of London and rises 135m above the city. There are 32 capsules attached to the wheel and each rotation takes 30 minutes, in which time you can marvel at the views that span up to 40km in all directions.

### MADAME TUSSAUDS

Founded by wax sculptor Marie Tussaud, this famous London attraction displays waxworks of historical and royal figures, film stars, sports stars and cultural icons. Filled with exciting, interactive zones, Madame Tussauds combines glitz and glamour with incredible history, featuring over 300 wax figures.

### OXFORD STREET

With 548 high shops, you can find absolutely anything you can dream about. Oxford Street houses the flagship stores of many famous brands and also hundreds of small shops. This street also includes landmarks such as Marble Arch, Selfridges and Oxford Circus.

### ROYAL ALBERT HALL

The Royal Albert Hall is one of the UK's most treasured and distinctive buildings, globally recognisable and internationally known for the annual summer Proms which have been hosted there from 1941. Since its opening by Queen Victoria in 1871, countless leading artists from around the world have appeared on the famous stage.

### HOUSES OF PARLIAMENT

Also known as the Palace of Westminster, the Houses of Parliament is home to the iconic Big Ben, and lies on the north bank of the River Thames. Located in the heart of London, it is close to the historic Westminster Abbey, the government buildings of Whitehall, the Prime Minister's residence of Downing Street, and is home to the House of Lords and House of Commons.

### KENSINGTON PALACE

First adapted for royal residence in 1689 by Sir Christopher Wren, Kensington Palace has been host to the courts of William and Mary, Queen Anne, George I and George II, and was the birthplace of Queen Victoria. In more recent times the Palace has been a much loved home for Princess Margaret and Diana, Princess of Wales, both of whom have played a part in transforming Kensington Palace into a fashionable royal residence.

### REGENT STREET

Named after Prince Regent (later George IV), Regent Street is one of the major shopping attractions in London. The layout of this street was designed by architect John Nash and completed in 1825. The Regent Street has been home to Hamleys, arguably the world's largest toy store, for over a century.

[hilton.com/londonparklane](https://hilton.com/londonparklane)

**LONDON HILTON ON PARK LANE**  
22 Park Lane | London  
W1K 1BE | United Kingdom  
T: +44 (0)20 7208 4045  
E: [events.parklane@hilton.com](mailto:events.parklane@hilton.com)

